



2 Binary Street Yatala QLD

- 600sqm* industrial building and office
- 2,327sqm* of total land area
- 557sqm* of clearspan warehouse area
- Side storage area with warehouse access
- 43sqm* of office and amenities area
- Large hardstand yard and dual driveway access
- New main power board
- Plans and pricing available for building extension
- Highly sort after rarely found
- Contact Exclusive Agents to inspect today

This unique opportunity is situated in the heart of the Yatala Enterprise Area. Ideally located between the two largest consumer markets of Brisbane and the Gold Coast with direct access from the M1 via Exit 38 and Exit 41 in both north and south directions.

Price : Contact Exclusive Agents
Building Size : 600 sqm
Land Size : 2327 sqm
View : <https://www.corwells.com.au/sale/qld/logan/yatala/commercial/industrial/6250074>



Paul Bates
07 3056 0588



Sam Griffiths
07 3056 0588

Schedule for 2 Binary Street, Yatala

Warehouse: 568sqm*

Office & Amenities: 39sqm*

Total: 607sqm*



UNAPPROVED
FIRST FLOOR
MEZZANINE

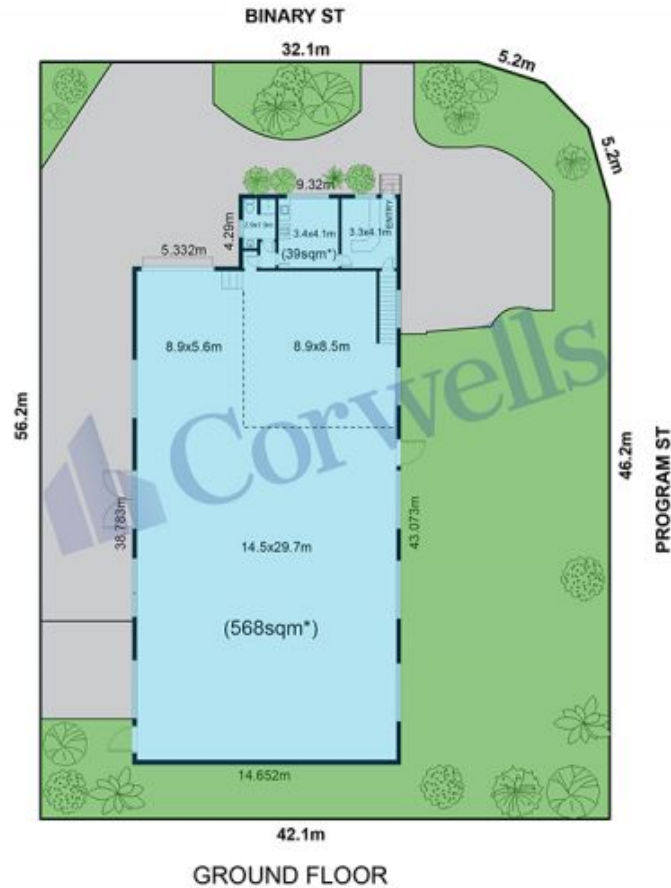

*This floor plan is intended as a guide only. Layout dimensions are approximate. No representations or warranties of any nature whatsoever are given or intended. Any person using this information should rely on their own enquiries.